



TEREX®

AL4000

Light Tower

LIGHT TOWER
AL4000



Features

- | | |
|------------------------------------------------------------------------------------------------------------------------------------------------------|----------------------------------------------------------------------------------------------------------------------------------------------------------------------------------|
| <ul style="list-style-type: none">• Full sized, 30 ft (9.1 m) extended height floodlight tower illuminates 7-1/2 acres. | <ul style="list-style-type: none">• Plug-in ballasts are installed in galvanized steel boxes. |
| <ul style="list-style-type: none">• Galvanized tower is 360° rotatable for easy aiming from the ground. | <ul style="list-style-type: none">• Light fixtures plug into weatherproof receptacle box with UL and CSA approved connectors. |
| <ul style="list-style-type: none">• Winch handle ergonomically positioned for easy raising and lowering. Winch drum is inside cabinet. | <ul style="list-style-type: none">• Retractable power cord automatically recoils into protective sleeve to prevent damage when raising, lowering and moving tower. |
| <ul style="list-style-type: none">• Light fixtures mount securely on mast for travel or can be left on crossarm. | <ul style="list-style-type: none">• Control panel located inside cabinet, protected from the elements. |
| <ul style="list-style-type: none">• Pallet pockets and lifting eye make unit easier to load and unload. | |

Light Tower AL4000

Specifications

Lamps	Metal halide 4 x 1,000 W
Generator	Brushless 60 Hz, 6.0 kw
Engine	Kubota diesel 13.6 hp
Fuel capacity	30 gal (114 L)
Wheel size	15 in (38 cm)
Axel rating	3,500 lbs (1,558 kg)
Tongue weight travel position	147 lbs (67 kg)
Total weight no fuel	1,950 lbs (885 kg)

Options and Accessories

Kubota diesel water-cooled, 13.6 hp/8.0 kW generator set
Perkins/CAT diesel water-cooled, 14.3 hp/6.0 kW generator set
50 hz, 7 kW generator Kubota engine
Auto-start/stop
50 gal (189 L) fuel capacity
Block heater
Combination ring/ball hitch
Ring hitch 2.5"
Tail light package
Electric trailer brakes
Hydraulic surge brakes (ring or ball hitch)
Electric 12 volt winch
12 Volt dome light with switch
Export racking/preparation
700 CCA battery
Fuel water separator with fuel line heater
Low temperature coolant mixture (-40 deg F)
Battery heater blanket
Roda Deaco air shutdown system

Dimensions

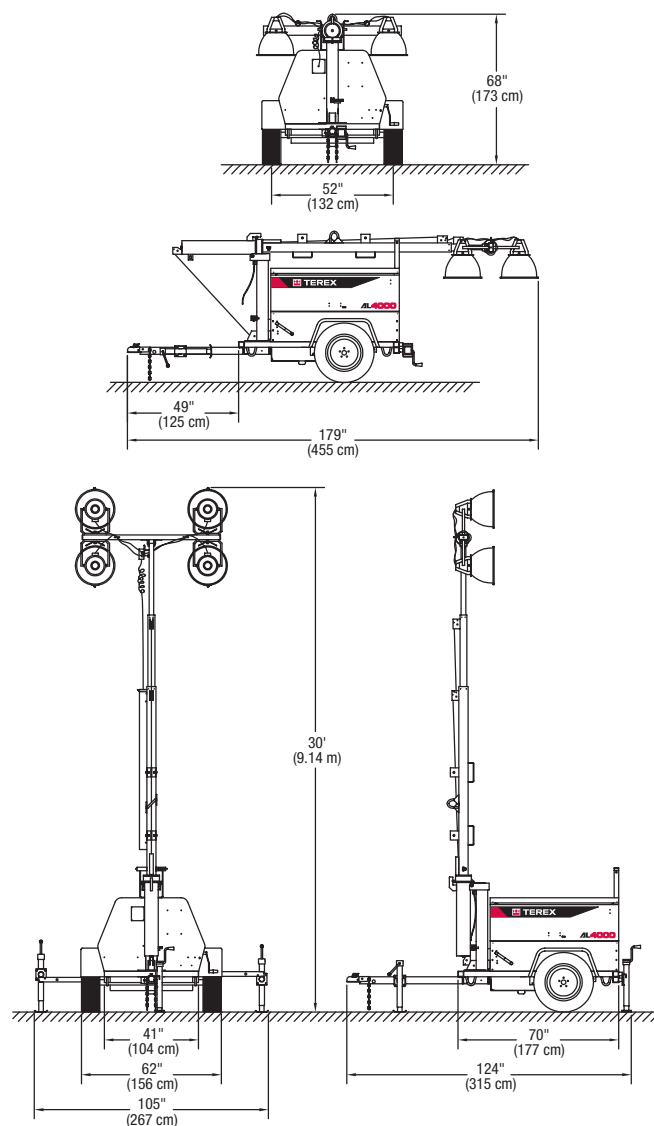

For more information, product demonstration, or details on purchase, lease and rental plans, please contact your local Genie distributor.



Genie Industries, Inc.
A Terex Company

18340 NE 76th Street
PO Box 97030
Redmond, WA 98073-9730

TEL +1 (425) 881-1800
TOLL FREE +1 (800) 536-1800
PARTS & TECH SUPPORT +1 (800) 228-6444
FAX +1 (425) 883-3475
WEB www.genieindustries.com

Effective Date: January, 2010. Product specifications and prices are subject to change without notice or obligation. The photographs and/or drawings in this document are for illustrative purposes only. Refer to the appropriate Operator's Manual for instructions on the proper use of this equipment. Failure to follow the appropriate Operator's Manual when using our equipment or to otherwise act irresponsibly may result in serious injury or death. The only warranty applicable to our equipment is the standard written warranty applicable to the particular product and sale and we make no other warranty, express or implied. Products and services listed may be trademarks, service marks or trade-names of Terex Corporation, Genie Industries, Inc. and/or their subsidiaries in the U.S.A. and many other countries. All rights are reserved. Terex is a registered trademark of Terex Corporation in the U.S.A. and many other countries. Genie is a registered trademark of Genie Industries, Inc. in the U.S.A. and many other countries. Genie is a Terex Company. © 2010 Terex Corporation.

AL4000 0210G Part #109045